

Duplex Mill & Mfg. Co.

Parts Price List

Prices subject to change without notice.

Corn Cutter and Graders

Price list number: DN1001-PL-PQW

Ref: 1598-8, #384, Effective: 1/1/01

Comments: published 1/18/01

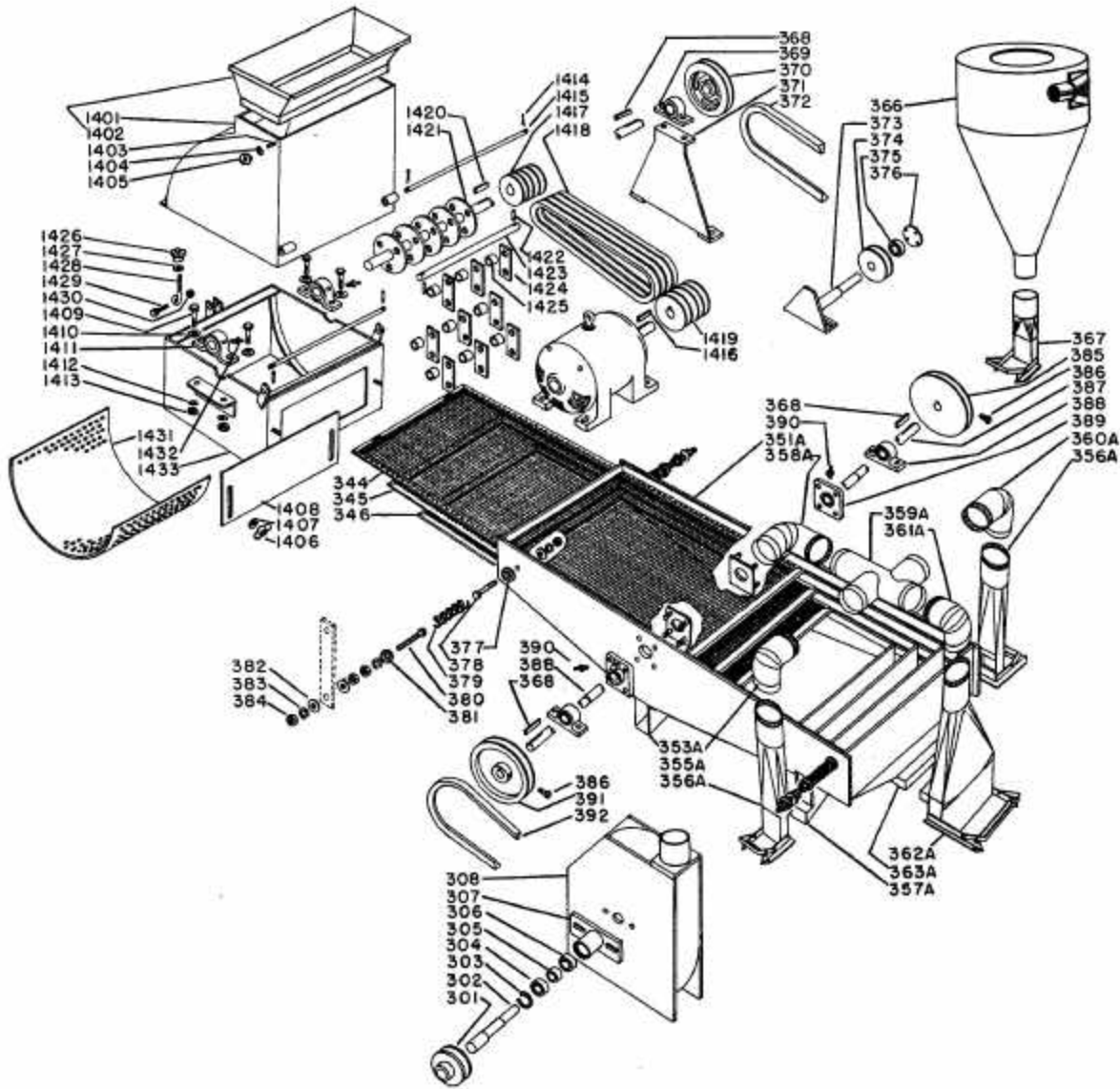

No. 15 CUTTER HEAD

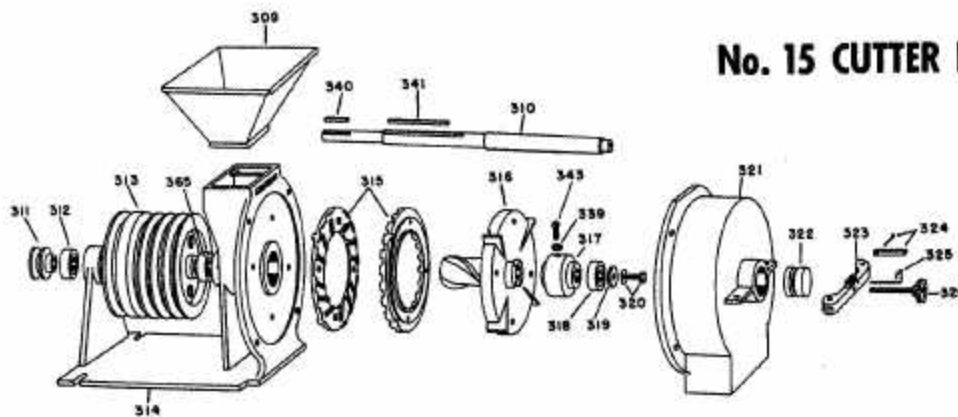

Duplex Mill & Mfg. Co.

Parts Price List

Prices subject to change without notice.

Corn Cutter and Graders

Price list number: DN1001-PL-PQW

Ref: 1598-8, #384, Effective: 1/1/01

Comments: published 1/18/01

Corn Cutter & Grader Repair Parts		
Part No.	Description	Price
0301 ¹	Fan driven sheave (1TB50 x 1-1/8") (For #222 and #333)	72.45
0302	Fan Shaft	187.70
0303	Lock Ring	7.85
0304	Ball Bearing (#6205)	67.75
0305	Bearing Spacer	74.30
0306	Ball Bearing (#6205)	67.75
0307	Bearing Housing	184.40
0308	Blower Housing w/Fan Old Style 1 pc. welded (Obsolete)	1510.00
0308A	Blower, less housing, NEW Style	393.60
0308B	Blower Housing, less fan NEW Style, No Shaft or Bearings	703.00
0308C	Complete Blower , new style, with fan, housing, shaft, bearings, spacer and bearing housing, no drive sheave	1426.00
0309	Feed Hopper w/2" x 2" Protective Grate for No. 15 Cutter head	233.75
0310	Main Shaft for #15 Cutter head	376.50
0311	1B x 3" Sheave	52.50
0312	Ball Bearing (106-0105) (4/10/00)	72.25
0313	5B x 8 1/2" Sheave	453.15
0314	Cutter Head Base	1504.00
0315	Cutter (2/Set) Model 15 – 15 1/2; 9" Burr Plates	378.00
--	For 9" Cutters – 1 Set (8) Bolts	19.80
0315A	Cutter (2/Set) Model 56 – 56 1/2; 6" Burr Plates	379.00
--	For 6" Cutters – 1 Set (6) Bolts	14.15
0316	Runner: Casting # : Mod 15 #G792; Mod 56 #G602	484.00
0317	Clutch Collar: Casting # : Mod 15 #G795; Mod 56 #G603	186.00
0318	Ball Bearing (106-0105) (4/10/00)	72.25
0319	Thrust Washer	7.50
0320	Cap Screw & Washer	3.50
0321	Cutter Housing: Casting #: Mod 15 #G791; Mod 56 #G760	1088.00
0322	Adjusting Plug	44.40
0323	Adjusting Bracket (G794)	72.45
0324	Adjusting Lock w/Cotter Pin	12.40
0325	Adjusting Spring	6.85
0326	Adjusting Screw	36.50
0339	Lock Nut	2.25
0340	Short Key	4.25
0341	Long Key	9.50
0343	Set Screw	4.60
0344	Upper Screen w/Frame Stainless Steel Screen (Std. Mesh is 8)	544.25

Duplex Mill & Mfg. Co.

Parts Price List

Prices subject to change without notice.

Corn Cutter and Graders

Price list number: DN1001-PL-PQW

Ref: 1598-8, #384, Effective: 1/1/01

Comments: published 1/18/01

Corn Cutter & Grader Repair Parts		
Part No.	Description	Price
0345	Middle Screen w/Frame Stainless Steel Screen (Std. Mesh is 10)	544.25
0346	Lower Screen w/Frame Stainless Steel Screen (Std. Mesh is 20)	544.25
0346A	Stainless Steel Screen, ONLY, Less Frame	227.00
0346B	Frames for Screen ONLY, Less Screen	349.00
0351	Shoe; Model #222 Suggested (1) of each Part #353A-357A & 363A	2,142.25
0351A	Shoe; Model #333 Suggested (1) of each Part #353A & 363A and (2) 357A	2,435.00
	Separate parts for either shoe	
	Bottom pan: 30-3/8" x 29-1/4" x 18 gauge, 2" break each side	148.00
	Bottom pan: 30-3/8" x 24-1/4" x 18 gauge, 2" break each side	146.00
0353A	Meal Spout	180.00
0355A	Side Drop Elbow (left)	93.50
0356A	Side Drop (Specify right or left)	216.00
0357A	Side Spout (Specify right or left, #222 or #333)	316.00
0358A	Elbow (Blower Intake)	61.75
0359A	Double Tee	374.25
0360A	Side Drop Elbow (right)	61.75
0361A	Front Drop Elbow	61.75
0362A	Front Drop	1118.00
0363A	Front Spout	341.00
0365	Ball Bearing (106-0020) (4/10/00)	68.50
0366	Collector – 20"	1031.20
0367	Collector Valve Drop	218.80
0368	Key	10.30
0369	Bearing For Cutter Shaft(!-7/16" SCM)	116.10
0370	Sheave (Shoe Drive Sheave, 1VP60 x 1-7/16" Variable Pitch)	262.40
0371	Bearing Support	197.00
0372	V-Belt (B-90, Cutter head to Shoe)	44.40
0373	Idler Pulley Bracket w/Shaft	269.10
0374	Idler pulley, cutter head to shoe drive (Duplex 1B 5" OD)	148.00
0375	Bearing for idler pulley (6205 with .985" shaft)	67.75
0376	Cap for idler pulley	51.40
0377	Spring Support	84.00
0378	Bolt	3.50
0379	Spring, each (HT) (One of 4 required for shoe suspension (116-2220)	97.50
0380	Bolt	3.50
0381	Spring Support Bushing	84.00
0382	Washer	2.30
0383	Lock Washer	2.30
0384	Nut	2.30

Duplex Mill & Mfg. Co.

Parts Price List

Prices subject to change without notice.

Corn Cutter and Graders

Price list number: DN1001-PL-PQW

Ref: 1598-8, #384, Effective: 1/1/01

Comments: published 1/18/01

Corn Cutter & Grader Repair Parts		
Part No.	Description	Price
0385	Sheave With Counterbalance Weight (One Each Side of Shoe) (8-3/4" OD x 1B Duplex with 18.5 oz. Counterweight) (116-2225)	324.30
0386	Bolt	3.50
0387	Eccentric Shaft, 1-5/8" turned to 1-7/16" (.187" eccentric) (40-1/2" long)	851.30
0388	Ball Bearing (Pillow Block) for Shoe (1-7/16" SCM)	116.10
0389	Ball Bearing (Flange) for Shoe (1-5/8" LB F3U226N)	218.00
0390	Zerk	4.80
0391	Sheave With Counterbalance Weight (One Each Side of Shoe) (8-3/4" OD x 1B Duplex with 18.5 oz. Counterweight)	224.30
0392	V-Belt (Shoe to Fan, B60)	29.65
1401	Cutter Top (Base is priced separately)	1,060.15
1402	Inlet surge hopper for cutter head	273.70
1403	Gate & Gate Hinge Rod	198.30
1404	Washer	2.70
1405	Gate Lock Nut	16.50
1406	Wing Nut	3.50
1407	Lock Washer	2.70
1408	Air Gate (Obsolete)	91.40
1409	Bolt	3.50
1410	Washer	2.70
1411	Ball Bearing; 1 7/16" (High Speed) (SCM) for Cutter Shaft	116.10
1412	Lock Washer	2.70
1413	Nut	2.70
1414	Pin	2.70
1415	Hinge Rod	34.30
1416	Key	13.75
1417	Sheave, Cutter Shaft Driven Sheave (7-1/2 HP = 3TB54 x 1-7/16")	260.50
1418	V-Belts, each belt: (motor to cutter head for 7-1/2 HP = B51, 3 needed)	26.25
1419	Sheave, Motor Shaft Drive Sheave (7-1/2 HP = 3TB50 x 1-3/8")	242.30
1420	Key	17.10
1421	Main Cutter Shaft w/Cylinder Discs, assembled (No Pins or Hammer Rods)	1940.90
1421A	Main Cutter Shaft, LESS Cylinder Discs	1391.65
1421B	Cutter shaft, discs, (3) rods, rod pins, (36) hammers, hammer spacers, assembled and balanced (no bearings)	\$3,016.00
1422	Pins (Per set of 6) (116-0465)	26.00
1423	Hammer Rods (Per set of 3) 1/2" Dia. hole	238.00
1424	Hammers (Per set of 36) 1/2" Hole (14 Ga.) (116-0421)	492.00
1425 ²	Hammer Spacers (Per set of 40) (116-0880)	320.00
1426	Cover Lock Handle	81.15

Duplex Mill & Mfg. Co.

Parts Price List

Prices subject to change without notice.

Corn Cutter and Graders

Price list number: DN1001-PL-PQW

Ref: 1598-8, #384, Effective: 1/1/01

Comments: published 1/18/01

Corn Cutter & Grader Repair Parts		
Part No.	Description	Price
1427	Washer	2.35
1428	Eye Bolt	66.50
1429	Bolt	4.25
1430	Nut	2.35
1431	Cutter head screen, 1/16" thru 1" (Specify Size)	192.00
1431A	Special screens other than 1/16" thru 1", minimum charge	662.00
1432	Grease Fitting	3.40
1433	Cutter Head Body (Top is priced separately)	2,606.80

Corn Cutter & Grader drawing reference list (12/1/98) – REFERENCE ONLY		
Drawing Number	Date	Description
DM0820	6/5/80	CC&G cutter head main shaft
DM1036 (1 of 2)	7/25/91	#333 CC&G Assembly & Parts
DM1036 (2 of 2)	7/25/91	#222 CC&G Assembly & Parts
DM1037 (1 of 2)	7/25/91	#333 CC&G Shoe, frame, sheet metal, spring
DM1037 (2 of 2)	7/25/91	#222 CC&G Shoe, frame, sheet metal, spring
DM1038	11/1/81	Hazard Warning Decal Sheet: #222 & #333
DM1602	3/1/84	Shoe Shaft
DM1616	8/9/94	Shoe for #222 CC&G
DM1651	5/1/84	Cam Roller Bagger Attachment
DM1826	11/13/84	Shoe for #333 CC&G
DM4407	10/28/97	Dust Hood (composite mold)
DM4413	12/1/97	Dust Panels: #222 & #333
DM4507	9/11/98	Standard MG hammermill (basic drawing)
DM4510	9/22/98	CC&G cutter head rotor assembly

¹ Part numbers 301 through 308, 366 and 367, and all part numbers on the No. 15 Cutter Head are also used on Models 15, 15-1/2, 56, and 56-1/2. Refer to Models 222 and 333 parts price list for description and prices.

² For part number 1425, rod spacers, see KD00010

Cutter sets for CC & G #15 and 15-1/2:

Standard coarse: G636 and G639

Medium: G638 and G639, or two pieces of plate #207

Fine: G251, two pieces

Cutter sets for CC & G #56 and 56-1/2

Coarse: G630 and G631

Fine: AN 01 and BN 01

Extra Fine: G385 and G639